



# Newsletter

FITLER SQUARE IMPROVEMENT ASSOCIATION, INC.



Come join us  
at the Fair -  
more details  
on page 5.

## Kenyatta Johnson, our new Councilman "who loves us back"

For those of you who weren't able to attend our Jubilee in October, the highlight of the night was a presentation of a \$25,000 grant from Councilman Kenyatta Johnson to Fitler Square for bench replacement, which at this time has been increased to \$37,000 to cover all costs. We are so fortunate to now have a Councilperson who is sincerely interested in our neighborhood and is supportive of Fitler Square, emotionally and financially. His efficient and considerate staff return phone calls and follow up on any requests, including my inquiry to interview him for this newsletter.

Kenyatta Johnson grew up, and still resides, in the Point Breeze neighborhood, where he attended Childs Elementary School and Bok High School and Missionary Baptists Church. He attended Mansfield University and holds a Masters Degree in Government Administration from the Fels Institute of Government at the University of Pennsylvania. He also has completed the Governing for Non Profit Excellence Certificate Program at the Harvard School of Business. Additionally, he served as State Representative for the 186th Legislative District from 2009 until 2012, when he took the oath of



office for City Council.

It was during his attendance at Mansfield that he first felt the need to serve the community. He told me how every school break he would return home to find another friend murdered through gun violence. In 1998, when his cousin was shot and killed, his anger and determination to end gun violence resulted in the organization he founded, Peace Not Guns. It began with a prayer vigil and a peace march, and combating gun violence remains his passion today.

But the Councilman is passionate about a lot of things, including his new puppy, a blue conorso named Sasha Blue, and his beautiful wife Dawn, who accompanied him to the Jubilee. When I

(Continued on page 4)

 Become a fan of  
Friends of Fitler Square

400 South Croskey Street  
Philadelphia, PA 19146  
[www.fitlersquare.org](http://www.fitlersquare.org)

**The mission of FSIA is to preserve, protect and beautify Fidler Square and we work in partnership with Philadelphia Department of Parks and Recreation.**

**Board of Directors**

**Honorary Director**  
Anne Rowland  
(Fidler relative)

**President**  
Judy Zimering

**Vice-President**  
Patty Fox

**Vice President & Grounds**  
Pat Henningsen

**Treasurer**  
Marlene Blume

**Membership**  
Derek Freres

**Newsletter**  
Amy Riley

**Chairman**  
George Malcomson

**Secretary**  
Cathy Nino

**Parliamentarian**  
Gene Rudolph

**Security**  
Jim Kenkelen

Cliff Eyler  
Phil Frank  
Lora Hemphill  
Lolly LaGreca  
Lenore Millhollen  
Maria Obropta  
Robin Salaman  
Lynn Schwartz  
Margaret Tobin  
Connie Williams  
Mark Willie



**A Message from our President:**

*Happy Spring, dear friends and neighbors:*

*2012 has been a great year for Fidler Square in many ways. We have increased membership to an all-time high of 338, we had a super successful Annual Spring Fair, and the year truly peaked at our Golden Jubilee party, where we raised over \$17,000 and Councilman Kenyatta Johnson pledged a grant to replace all of our benches.*

*There is a lot of work to be done in the Square and at the March Board meeting of the Fidler Square Improvement Association, as our Treasurer Marlene Blume gave her report, I was reminded of the U.S. Government signs that have sprouted up everywhere... "YOUR TAX DOLLARS AT WORK." So we came up with our own version... "YOUR MEMBERSHIP DOLLARS AT WORK." And here are a few projects currently underway in the Square:*

*Tree Work:*

*Pruning to remove all dead, diseased, and broken branches to improve health and reduce risk of branch failure. Remove diseased sugar maple tree in the west garden.*

*Plant two new trees.....\$8,636.00*

*Brick and concrete repair, Phase I.....\$5,355.00*

*Ongoing Maintenance and Gardener costs.....\$8,500.00*

*We are able to make these improvements with the funds we have raised through our membership and we have great plans to do more improvements in the future! And we are always concerned with safety in the square, so in the upcoming months, we intend to correct all of the loose bricks in the park, a daunting project since there is concrete underneath the brickwork that will need to be removed.*

*So please be assured that your dollars are spent for the good of the park and the community, and help us by attending and/or volunteering at our Annual Spring Fair on Friday and Saturday, May 10 and 11, our biggest fundraiser of the year.*

*On a final note, I would like to thank Philadelphia Parks and Recreation for their support, especially the plumbers and masons who are repairing our beautiful Victorian water fountain.*

*Warmest regards,  
Judy*



Prudential

**Fox & Roach, REALTORS®**

Rittenhouse Square Sales Office • 1818 Rittenhouse Square  
Philadelphia, PA 19103 • Phone: 215-893-9800

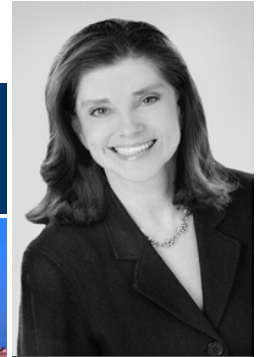

**Lora Hemphill**  
Associate Broker  
(215) 732-2073  
lora@lorahemphill.com

Proud Sponsor of FSIA 2012 Golden Jubilee  
FSIA Board Member



[www.lorahemphill.com](http://www.lorahemphill.com)

**YOUR BEST RESOURCE FOR PHILADELPHIA REAL ESTATE**  
Center City ~ Main Line ~ Chestnut Hill

"We turned to Lora as our selling agent, since she lives in the Fidler Square neighborhood and we had seen her countless times prepare homes for showings. And needless to say, we were not disappointed. She staged the home with such great enthusiasm. We left Philadelphia long before the transaction was finished, and yet, we never had to worry. Lora took care of everything in our absence."

- Dr. Thomas & Claudia Andl



Dear Friends and Neighbors,

It's a pleasure to be your Fidler/Rittenhouse Square Real Estate Expert, living and working in the community for over 20 years. I have **successfully listed and sold residential and investment properties** in our neighborhood over the years.

You can trust my knowledge, experience, and resources to help you **Buy, Sell or Rent** a property while exceeding your expectations. And, ask me about our **Worldwide Relocation Services**. Feel free to contact me at **(215) 732-2073 Direct** or visit my website **www.lorahemphill.com**.

**I am truly devoted to serving all my clients and building long-term relationships. You have my commitment to excellence and attention to all the details necessary in handling your unique requirements. After all, you deserve the best!**

Sincerely,

*Lora H.*



An Independently Owned and Operated Member of the Prudential Real Estate Affiliates, Inc.



## Kenyatta Johnson

(Continued from page 1)

asked him where he had met Dawn, his face lit up as he told me she was actually his supervisor in the office of his political mentor, State Senator Hardy Williams, where they developed a friendship while working together and then he, as he puts it, "won the jackpot" when they became husband and wife.

When asked what his favorite part of the job is, he responded, "the smiling faces when you are able to address issues and concerns" of his constituents. He admits it's a demanding job and there are a lot of issues to address, but he is confident that together we can do great things.

When I asked Councilman Johnson if he ever "hangs out" in Fitler Square, he answered, of course, he and Dawn walk through the Square to the Schuylkill River Trail for their daily exercise.

Councilman Johnson's leadership and concern for not only our neighborhood but all of the neighborhoods in his Councilmatic district, and our city in general, make him truly "a man with a mission to serve."

*Special thanks to Yvette Ousley, Director of Communications for Councilman Johnson, for her assistance.*

## Trinity at 22nd

**Spirituality • Compassion • Culture**

### Trinity Memorial Church

*I find great joy in our TMC community and the shared witness of our faith journeys! ~ Teri*

### Community OutReach Partnership

*Communicare gave me the chance to set up a computer for Ms. J., who is 82 and blind. She was excited by her new toy and I was inspired – I hope that I'm still eager to take on something new when I'm 82! ~ Sharon*

### Trinity Center for Urban Life

*Trinity Center is a beating art-heart. I love it for bringing our neighborhood a world of artistic variety, expression and inspiration. ~ Sue*

**The Center of Your Neighborhood  
at the corner of 22nd & Spruce Sts.**

2212 Spruce St.  
Philadelphia, PA 19103  
215-732-2515



Trinity Memorial Church



trinityat22nd.org



## Securing the future of our community is just as important as securing the future of our clients.

That's why we're a proud sponsor of Fitler Square Improvement Association

John Fischer is pleased to support the important work of Fitler Square Improvement Association. A strong partnership in making our community a better place to live and work.

John Fischer  
CLU®, ChFC®, CASL™  
Financial Advisor  
The Philadelphia Group  
nmfn.com/johngfischer

 **Northwestern Mutual**

insurance / investments / ideas\*

05-2813 © 2011 The Northwestern Mutual Life Insurance Company, Milwaukee, WI (Northwestern Mutual). John Getz Fischer is an Insurance Agent of Northwestern Mutual (life and disability insurance, annuities) and a Registered Representative and Investment Adviser Representative of Northwestern Mutual Investment Services, LLC (securities), a subsidiary of Northwestern Mutual, broker-dealer, registered investment adviser and member FINRA and SIPC.



## ATTENTION ALL ARCHITECTS (AND FITLER SQUARE LOVERS, TOO!)

As reported in our Fall Newsletter, we were saddened by the loss of our good friend and neighbor Helene Morlok. A fund has been set up in her name and we would like to use the money to spruce up the shed. We are looking for ANY IDEAS that you may have to beautify the existing shed, keeping the Victorian style of the Square in mind.

If you are an architect, artist, designer, or just someone with a great idea to help us beautify the shed, please send us your suggestions. We will sincerely review all entries and suggestions with Helene's husband Bill, an architect, and come to a final decision by summer's end.

Any and all entries or suggestions can be e-mailed to [fsia1962@gmail.com](mailto:fsia1962@gmail.com) or mailed to FSIA, 400 South Croskey Street, Philadelphia, PA 19146.



## Our 52nd Annual Spring Fair

Friday and Saturday, May 10th and May 11th -  
RAIN OR SHINE

Come join us as we celebrate our neighborhood and our beautiful park with the biggest fundraiser of the season. We will have music, food and fun. The following booths will be featured:

**White Elephant booth:** There are always special treasures to be found here. Items include household treasures, fun stuff and jewelry. One year, we found an antique silver mug!

**Plant booth:** We sell the finest, healthiest flowers direct from Didden's Nursery. Come buy your Spring annuals and contribute to Fitler Square at the same time.

**Book booth:** Beautiful, gently read books available at a very reasonable price. There are tapes and CDs, too.

**Kids Toys and Clothing booth:** A great place to find almost-new clothes for infants, toddlers, and children.

**Food and Baked Goods booth:** We have combined our delicious hot dogs and homemade salads with the fabulous baked goods donated by our neighbors and neighborhood cafes.

**Kids booth:** Our fun craft booth for kids run by kids. Saturday it features a Moonbounce - 10am to 2pm.

**T-shirts and Stationery booth:** Show your pride and buy a Fitler Square t-shirt or hat; all sizes available.

**Raffle and Silent Auction booth:** Buy raffle tickets to our Chinese Auction, 6 for \$5, or bid on a donated treasure.

## ENTERTAINMENT:

Currently scheduled:

Friday from 3 to 4pm

Cris and Lou: Special  
Entertainment for toddlers

Friday from 4 to 4:30pm

A Capella chorus from The Philadelphia School,  
under the direction of Shannon Coulter

Saturday from 9:30am to 12:30pm

City Lites: A ragtime/Mummers sound

Saturday from 12:30 to 1:30pm

Cris and Lou: Repeat performance

Saturday from 2 to 4pm

The Lewis Brothers: Blues band



# "We do more than Open Doors"

## "Committed to the Community"

- |                        |                        |
|------------------------|------------------------|
| 2050 Pine St.          | 1806 Rittenhouse Savoy |
| 2212 Pine St.          | Phoenix 1600 Arch St.  |
| PARC Rittenhouse       | Ritz Carlton 16F       |
| 620 Fitzwater St.      | 426 S. Taney St.       |
| 400 S. 22nd St.        | 112 Elfreth's Alley    |
| 1631 Kater St.         | 1207 S Broad           |
| 219-29 S. 18th St. 510 | 1821 Fitzwater         |
| 718 N. Uber St.        | 1919 Chestnut St.      |



**KATE FEDERICO  
KATHLEEN FEDERICO**



**PREFERRED**

1401 Walnut Street, 8th Floor  
Philadelphia, PA 19102  
www.cbpref.com

**Office:** 215.546.2700 x1079  
**Direct:** 267.238.1059  
**Cell:** 215.840.0049  
kfederico@cbpref.com  
katef@cbpref.com

River to River | Townhouse  
New Construction | Co-op  
Condo | Commercial

© 2011 Coldwell Banker Real Estate LLC. Coldwell Banker® is a registered trademark licensed to Coldwell Banker Real Estate LLC. An Equal Opportunity Company. Equal Housing Opportunity. Owned and Operated by NRTLLC.

## Pine Street Dentistry

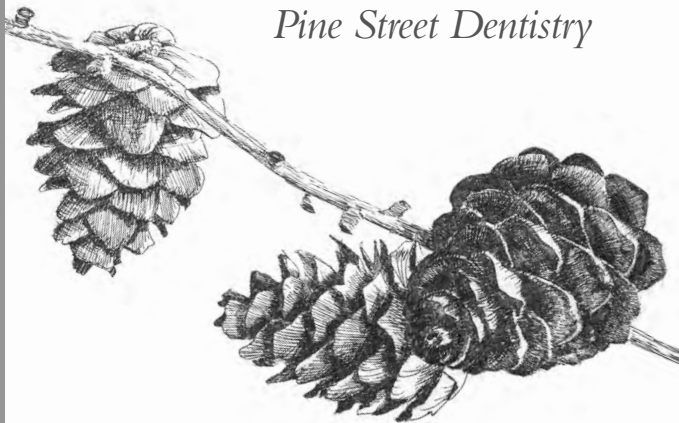

**Eric S. Cantor, D.D.S.**

1903 Pine Street  
Philadelphia, PA 19103

215.546.8195  
[www.PineStreetDentistry.com](http://www.PineStreetDentistry.com)



**BARTLETT  
TREE EXPERTS**

SCIENTIFIC TREE CARE SINCE 1907

**John Studdy  
Arborist Representative**

**Bartlett - Serving  
Philadelphia Since 1921**



PA Lic. #6160



## Park Stewardship Forum

By Cliff Eyler

The Philadelphia Parks and Recreation Department held a Park Stewardship Forum on February 23rd 2013, to mark the 20th anniversary of the Park Stewardship Program. The program offered a chance to reflect on the present state of Philadelphia parks and plan for the future of the Philadelphia Parks system.

Presenters spoke about the history of Fairmount Park and how it merged over time with the City of Philadelphia Recreation Department. One of the keys to the past, present, and future is the hard work of volunteers and civic groups to support our parks.

The forum focused on connecting participant park friends groups with key park contacts (both at the Fairmount Park Conservancy and Philadelphia Parks



and Recreation). Love Your Park Week, from May 11th to May 18th was another topic and Parks and Recreation has chosen Saturday May 11th as a Service Day. There will be city-wide promotion of the event.

Participants in the Forum had two break-out sessions; one, to discuss general and specific problems relating to their parks, and a second, to think about future plans and how groups envision a future five years from now.

610-449-2147  
email: [tnatalini@comcast.net](mailto:tnatalini@comcast.net)  
[www.nataliniandsons.com](http://www.nataliniandsons.com)

*Tom Natalini & Sons*  
MASONRY AND MASONRY RESTORATION  
SPECIALIST



7854 Beverly Blvd.  
Upper Darby Pa 19082



**All Women Painting**  
**215-868-4152**  
[allwomenpainting@gmail.com](mailto:allwomenpainting@gmail.com)  
<http://www.allwomenpainting.com>



**ZsuZsi Apati**

# DMITR'S



23rd and Pine 215.985.3680  
3rd and Catherine 215.625.0556  
944 N. 2nd Street 215.592.4550

**Your membership dollars at work...**

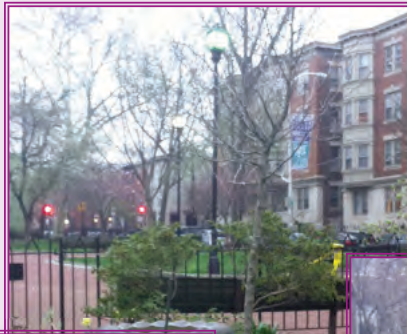

*Thanks  
for your  
support!*

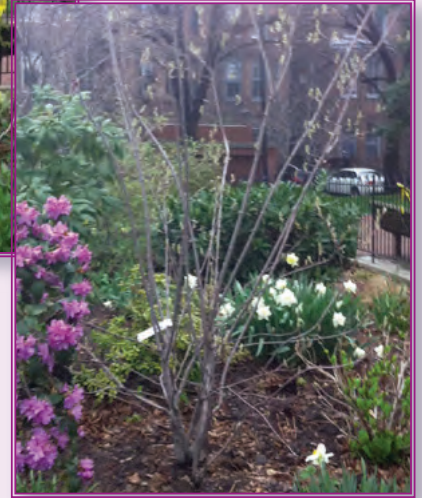

**Fidler Square  
Improvement Association, Inc.**  
400 South Croskey Street  
Philadelphia, PA 19146